

Warning: Before drilling into your boat, please check that you have clear access to the area beneath and that no objects, wires, or other hazards are present.

Tip: Do not measure from windscreen, cleats or vents. These reference points are not always square and in the same position as the opposite side of the boat. It's the best to use the front of the boat as the reference point, the top edge of the deck mould, or similar measurement points whenever possible. Always triple-measure and check before drilling.

Tighten the deck mounts firmly so that the mounts will rotate under pressure while turning the mount with the leg attached (note the mounts will be very hard to rotate by hands)

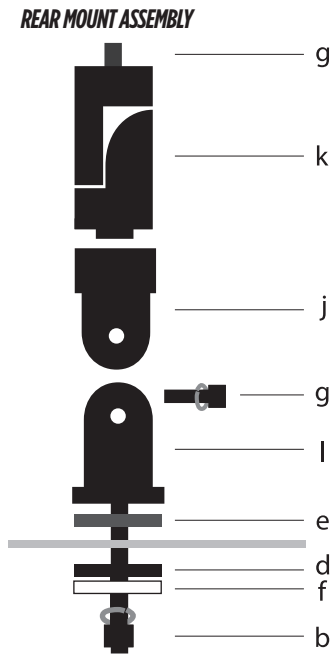

FRONT MOUNT ASSEMBLY

Step 6
Attach the tower onto the deck mounts. To make your job easier, you can remove the short front curve legs from the tower assembly at this stage, and move the front horizontal bars in or out to fit the rear deck mounts and connect it with M12 washer and bolts. Then lift the tower and re-assemble the curve legs on, rotate it to fit the front deck mounts, and connect to the mounts with M12 bolts and washer.

NOTE: When you have a narrow boat you probably need to shorten the overhead bar to make the tower fit to your boat.

Step 7
Drill through the predrilled holes in the center section from each side with size 10 drill bit and install bolts and cap nuts. One person will still be stabilizing the tower through this step. Tighten all hardware for completion of tower installation.

Step 8
Double check If the tower is in the correct position you can fasten all the bolts and screws

- How to fold the tower
- I. Disconnect tower front legs from the deck mounts.
 - II. Loosen the connection between the front legs and rear legs.
 - III. Push the tower top it will fold from front to down position.

- Care and maintenance
- I. Be sure to check and tighten all fasteners and connections prior to every use.
 - II. Be cautious when driving under obstacles, low hanging structures or trees with your tower mounted.
 - III. Use soap and water or general cleaners to clean your tower. Avoid abrasive materials that might scratch the bimini's finish.
 - IV. Always rinse tower after contact with salt (brackish) water.

JOBE Addict Tower Warranty
Jobe Sports International warrants this product (not including other 3rd party accessories) against manufacturers defects. Anodizing and powder coated surfaces as well as all hardware corrosion are specifically excluded as their care and use cannot be controlled by Jobe Sports International. Any modifications or improper use shall void this warranty. Jobe Sports International is not responsible for personal injury or damage to the boat caused by the use of this tower. JOB

Distributed by:
Jobe Sports International
Heerewaardensestraat 30, 6624 KK Heerewarden
The Netherlands WWW.JOBESPORTS.COM



ADDICT SWEPT FORWARD WAKEBOARD TOWER

INSTALLATION GUIDE



Operating under the theory that an ounce of prevention is worth a pound of headaches, here is some useful information that will prevent any scratching during the Wakeboard Tower assembly.

As you are taking the arms and top center section out of the box, place masking tape strips around the top conjunction sections of the tubes that slide inside. This allows you to move and adjust the tubes without scratching the surface. But please use caution when sliding the sections together. Keep the masking tape in place through the final assembly step, then, after drilling, remove the masking tape and your surface will be perfect.

Note that this installation guide is only a guideline. Each boat is different and improvisation is needed to mount your tower on your boat. We advise you to have your tower mounted by a professional who has experience in boat constructions and mounting other towers. All hardware is to be hand tightened. Do not use air tools or electric drills to tighten hardware. Tower is designed for one rider at a time. Do not tow tube riders or multiple riders with tower.

Contents of Box Inspect the package for missing or damaged parts caused by shipping.

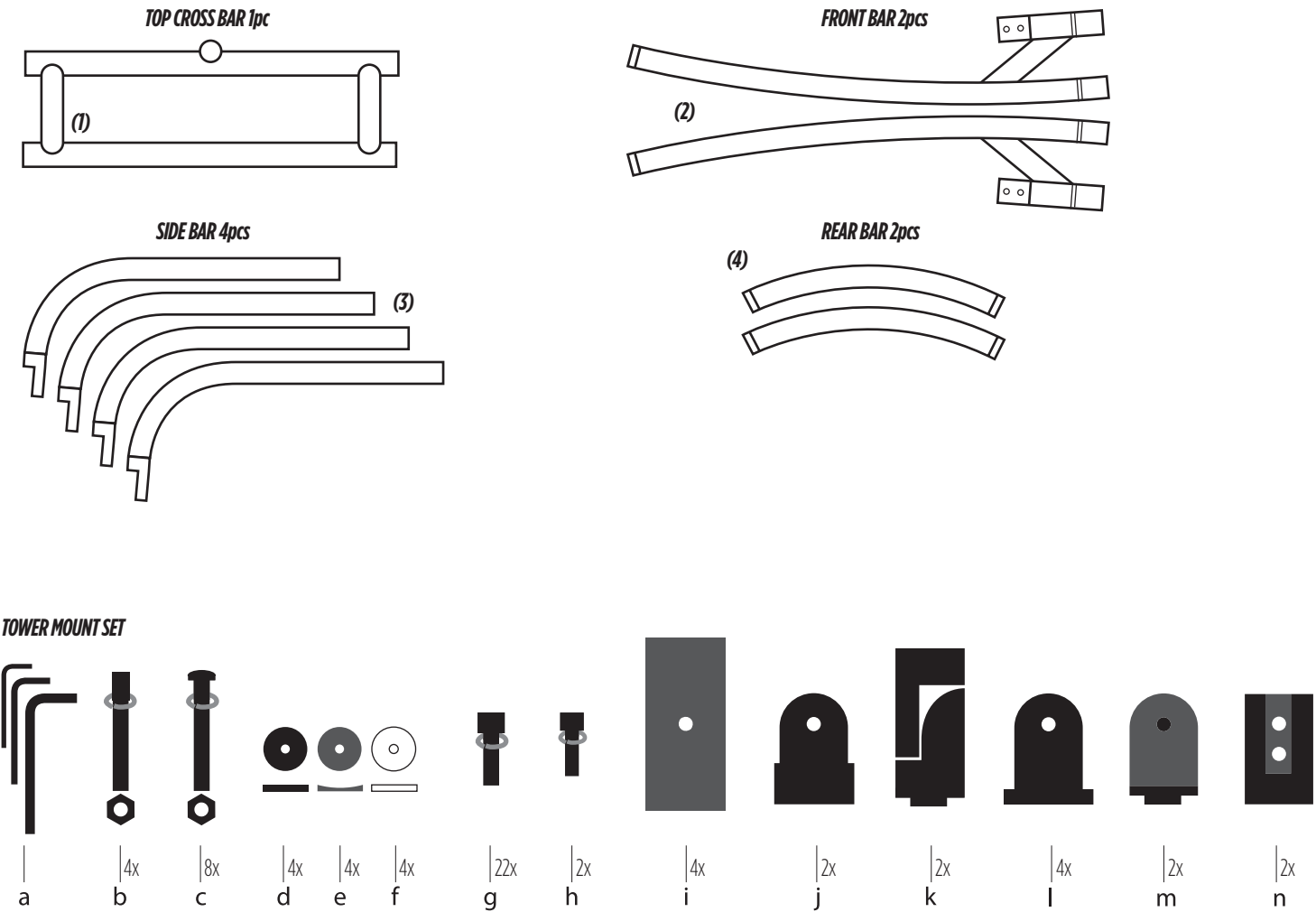

Step 1
Please attach the 2x small curved legs onto the 2x long legs with the fittings and bolts, don't forget to use the washer with the bolt. Don't tighten the bolt.

Step 2
Connect the 2x short L arms with the left and right legs using the M12 bolts and washer.

Step 3
Insert above horizontal bar into the top section, then insert the other 2x L arms into the top section and at the same time connect the L arms onto the opening legs, and lift the tower assembly on the ground, do not tighten any bolts at this stage.

Step 4
Put the tower assembly on the boat and find the best position it could sit, keep in mind this is a facing forward tower, make sure the tow point towards rear. The horizontal bar could be moved in or out to fit the width between the rear mounts, the 2 curved legs could be rotatable to fit the width between the front mounts. If you are not sure where is the best position to install the tower, please see the right picture for a reference.

Step 5
Determine the exact position for the deck mount and make a mark, install the deck mounts onto your boat. IMPORTANT: When the BOAT DECK is less than 10mm thick we strongly advise to reinforce the mounting bracket with wood or fiberglass cloth. Reinforcement should be as big as possible. This prevents stress on the boat which causes the gelcoat to crack. WARRANTY DOES NOT COVER: Any cracks or other damage to the gelcoat or boat because of mounting the tower.

Snug the bolt but do not fully tighten at this point.

